



Anchor Stores: Sears, Burlington Coat Factory
 National & Local Tenants: Kress, Marianne, Payless Shoesource, Novus, Me Salvé, Sears Homelife, Burlington Shoes and Baby Depot
 Hours of Operation: Mon - Sat: 9am - 9pm / Sun: 11am - 7pm
 Location: SR. 2 & Main Ave. Bayamón, Puerto Rico
 Parking Spaces: Multi-level, over 2,000 spaces
 Gross Leasable Area: 503,610 Sq. Ft.



	1 mile	3 miles	5 miles
Population	24,538	213,428	480,120
Households	9,161	70,738	161,238
Average Income	\$28,050	\$34,163	\$33,164



FOR LEASING OPPORTUNITIES PLEASE CONTACT US AT:

T 787 622 9600 x.120 / 128 / 105 • F 787 277 9601
 PO Box 362983, San Juan, Puerto Rico 00936-2983

Plaza Caparra, Suite 201
 1498 Roosevelt Ave. & Parkside St.
 Guaynabo, Puerto Rico 00968

ymelendez@ccmpr.com
 cdenis@ccmpr.com
 orosado@ccmpr.com

www.ccmpr.com

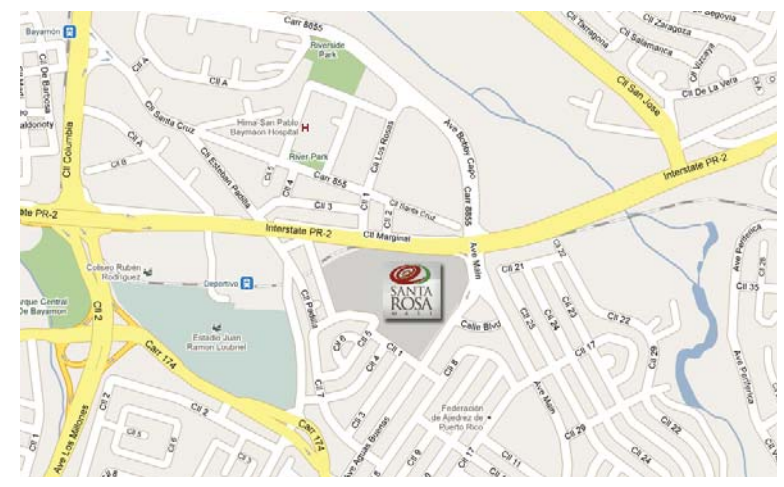

Ground Level

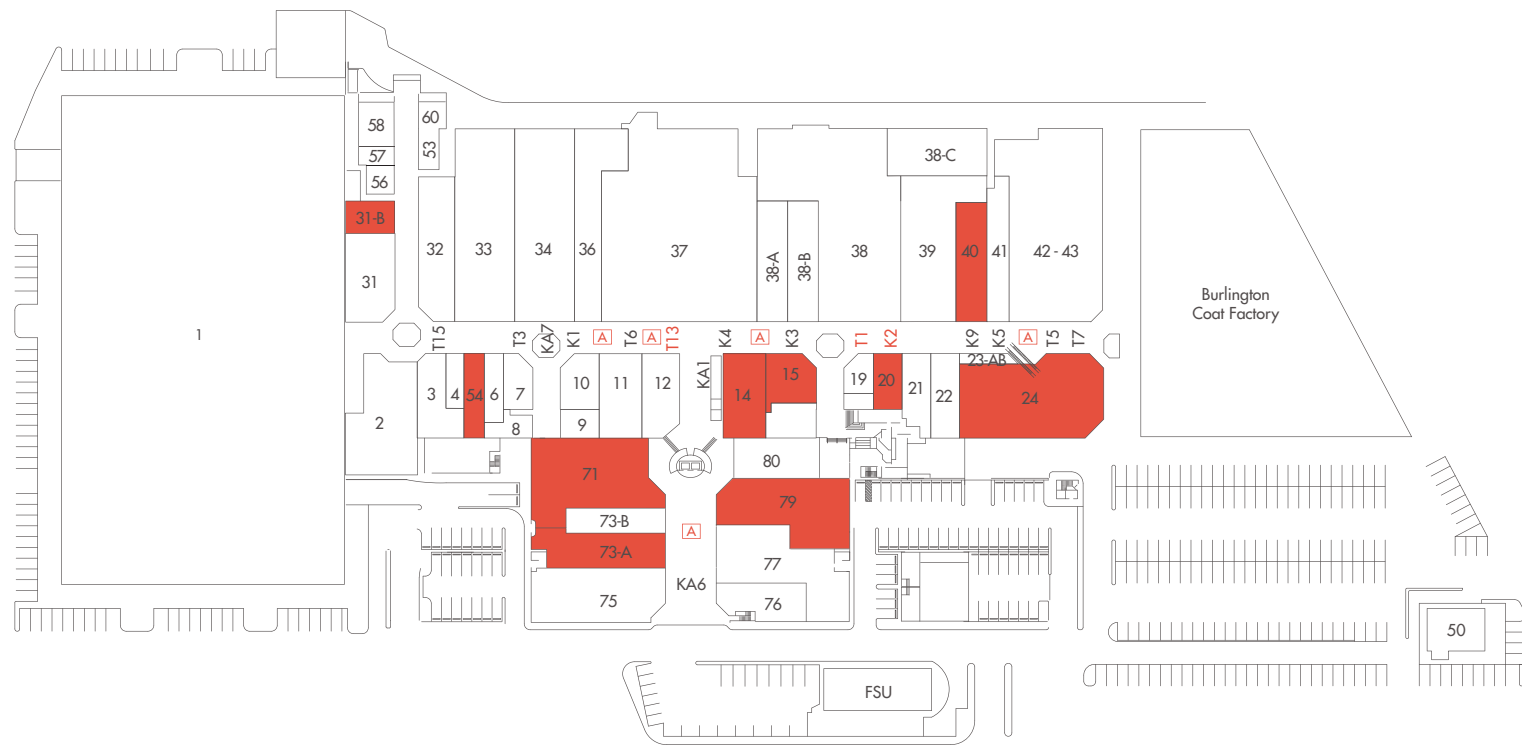

Level 2: Offices

Food Court

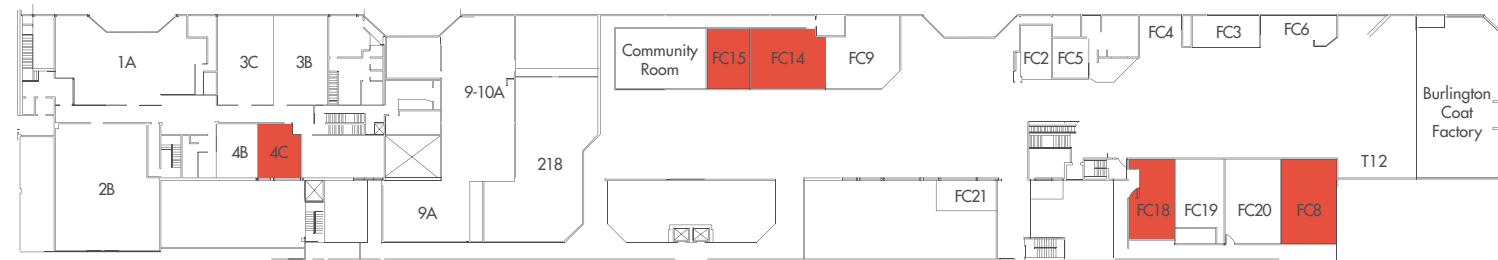

Level 4: Offices

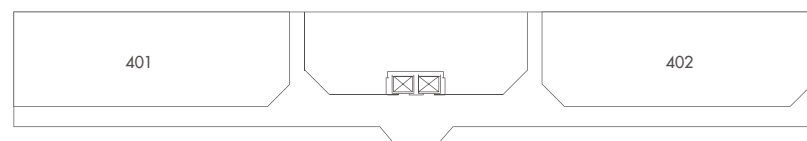

Unit	Sq Ft	Name	Unit	Sq Ft	Name
1	220,640	Sears Roebuck and Co.	K4	160	T - Mobile
2	5,200	Almacenes Plaza	K5	100	JM Fast Keys
3	2,057	Bakers	K6	160	AVAILABLE
4	460	Music & Tech	K7	160	AVAILABLE
6	960	Claire's Boutique	K8	80	AVAILABLE
7	1,947	Pearle Vision Center	K9	128	Open Mobile
8	679	Musicali	KA1	929	Cookies & More
9-10	2,172	Golden Palace	KA6	160	Claro
11	2,514	All Ways 99	KA7	60	Claro
12	1,850	Dress My Tablet			
14	2,751	AVAILABLE	Cart Stands		
15	2,053	AVAILABLE	T1	50	AVAILABLE
19	1,053	Baby & Kids Boom	T3	100	Boost Mobile
20	1,119	AT&T	T4	50	AVAILABLE
21	1,500	Journey's	T5	64	Lebiram Steel
22	1,693	Exentrix	T6	50	Coamo Satellite
23A/B	356	LA'mour Perfumes	T7	50	Dress My Cellu
24	7,558	AVAILABLE	T11	64	DirectV
31	2,747	Novus	T12	140	Café Monte Riqueño
31B	1,344	AVAILABLE	T13	50	AVAILABLE
32	3,600	Sirens	T15	100	Joyería La Familia
33	8,417	Rainbow			
34	8,000	Almacenes Kress	Offices		
36	4,320	La Defensa	1A	2,250	Dr. Pablo López Baez
37	24,850	Sears Homelife	2B	2,284	Prestige Marketing Enterprises
38	12,895	Baby Depot	3B	898	Santa Rosa Dental Center
38A	2,500	Click	3C	928	Programa Planificación Familiar
38B	2,500	Footlocker	4B	1,170	Santa Rosa Administration Office
38C	4,185	One Stop Auto Care	4C	359	AVAILABLE
39	6,624	Me Salvé	9/10A	3,145	Beautiful Body
40	2,200	AVAILABLE	218	2,427	Dr. José G. Amy - Fisiatra
41	2,090	General Nutrition Center	401	2,595	VRG Investment
42/43	12,485	Burlington Shoes	402	2,423	Triple S
44/49	70,000	Burlington Coat Factory			
50	2,123	Church's Chicken	Food Court		
54	1,173	AVAILABLE	FC2	360	Baby Bull
56	920	The Salon & Co.	FC3	465	Subway
57	593	Easy Print	FC4	231	Sabor Criollo
58	1,742	US ARMY	FC5	862	KFC
53/60	1,393	Quest Diagnostics	FC6	410	Taco Maker
71	3,554	AVAILABLE	FC8	782	AVAILABLE
73A	4,062	AVAILABLE	FC9	999	Burger King
73B	2,802	Payless Shoesources	FC14	728	AVAILABLE
75	4,960	Banco Popular De P.R.	FC15	478	AVAILABLE
76	1,970	H&R Block	FC18	704	AVAILABLE
77	5,874	First Bank	FC19	661	The Top Potato, Inc
79	5,179	AVAILABLE	FC20	890	Red Lantern
80	2,409	Zales Jewelers	FC21	363	Plato di Pasta
FSU	5,000	Denny's Family Restaurant			
			Kiosks		
K1	200	Dulces Detalles			
K2	258	AVAILABLE			
K3	169	Universal Sunglass			